

FEED PUSHER

# RANGER

V3



Self-guided & autonomous feed pusher.

The most reliable on the market.



3990 State Rt. 14, Columbiana OH 44408  
(330) 482-1522

## DETAILS

### •New optimized 4.0 features!

- WiFi connectivity, smart remote control, device condition information, events history, simplified diagnosis, etc.
- Automatically adapts the food pushing distance to the curb, with no programming
- Simple, efficient and reliable thanks to the ground-inserted magnet strip
- No risk of loss of control
- Increased consumption of ration and milk production according to journal of animal science
- Motorized bi-directional rotating skirt increases pushing efficiency
- Low maintenance

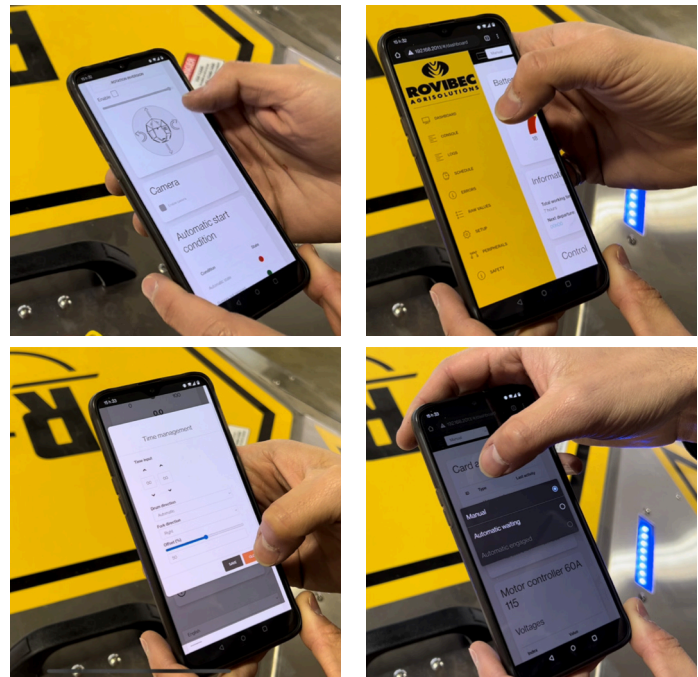

## TECHNICAL DRAWING

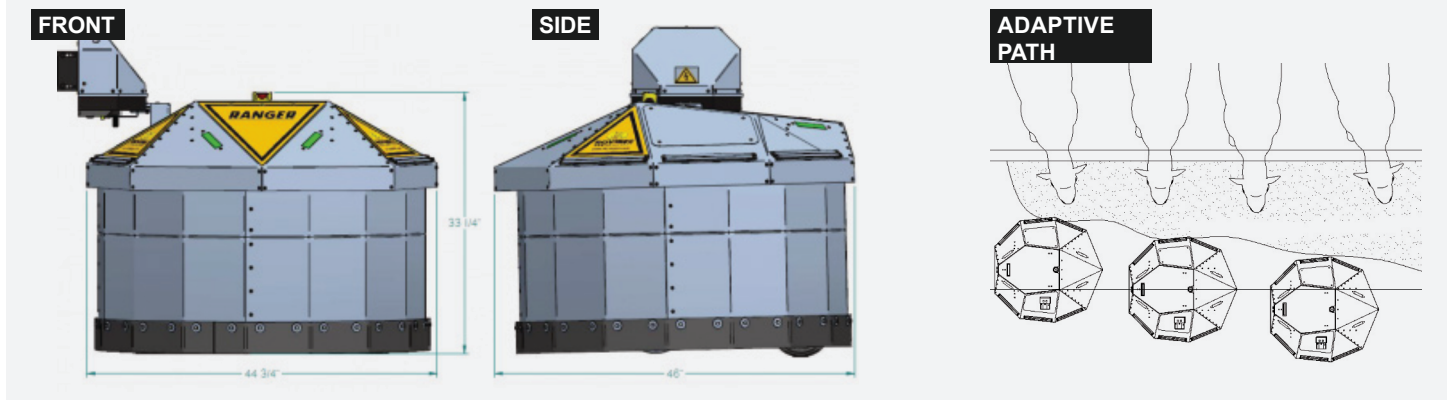

## SPECIFICATIONS

<b>POWER</b>	Electric 24V DC
<b>BATTERY</b>	4 X 60 amp/hrs - 12V DC AGM battery -
<b>RECHARGE</b>	Automatic charger using 24V DC- 15 AMP operating on 120/240 VAC. Multiple charging locations available as an option
<b>TRACTION</b>	2 X 1/2HP (375 W) Electric motor (1 per wheel)
<b>SPEED</b>	40 ft/min (0.2m/s)
<b>ROTATING SKIRT</b>	Motorized, bi-directional - independent 0.4 HP (300 W), urethane rubber
<b>OPERATING RATIO – CHARGING/ RUN TIME</b>	50/50
<b>MAX RUNNING TIME</b>	1h - 2400 ft (730 m)
<b>GUIDING SYSTEM</b>	1/8in X 1/2in (3,2mm X 12,7 mm) magnetic strip inserted into grooved floor
<b>MANUAL MODE</b>	Userfriendly smartphone application and/or wired control
<b>WEIGHT</b>	1335lbs (610 kg)
<b>PUSHING FORCE</b>	400 Lbs (180 kg)
<b>DISTANCE TO THE CURB</b>	Adaptive path, up to 24" (60 cm)
<b>SHIELD AND COVER</b>	304 Stainless steel
<b>FRAMEWORK</b>	Powder coated paint
<b>MINIMUM SPACE REQUIRED FOR HALF-TURN</b>	57" (145 cm)
<b>SAFETY</b>	Temporary stop on collision
<b>NEW FEATURE</b>	Wi-fi connectivity, email notification, event history, simplified diagnosis